

PLOT NO.		AREA IN ACRES		TOTAL AREA	
1	1.0	1.0	1.0	2.0	2.0
2	1.0	1.0	1.0	2.0	2.0
3	1.0	1.0	1.0	2.0	2.0
4	1.0	1.0	1.0	2.0	2.0
5	1.0	1.0	1.0	2.0	2.0
6	1.0	1.0	1.0	2.0	2.0
7	1.0	1.0	1.0	2.0	2.0
8	1.0	1.0	1.0	2.0	2.0
9	1.0	1.0	1.0	2.0	2.0
10	1.0	1.0	1.0	2.0	2.0
11	1.0	1.0	1.0	2.0	2.0
12	1.0	1.0	1.0	2.0	2.0
13	1.0	1.0	1.0	2.0	2.0
14	1.0	1.0	1.0	2.0	2.0
15	1.0	1.0	1.0	2.0	2.0
16	1.0	1.0	1.0	2.0	2.0
17	1.0	1.0	1.0	2.0	2.0
18	1.0	1.0	1.0	2.0	2.0
19	1.0	1.0	1.0	2.0	2.0
20	1.0	1.0	1.0	2.0	2.0
21	1.0	1.0	1.0	2.0	2.0
22	1.0	1.0	1.0	2.0	2.0
23	1.0	1.0	1.0	2.0	2.0
24	1.0	1.0	1.0	2.0	2.0
25	1.0	1.0	1.0	2.0	2.0
26	1.0	1.0	1.0	2.0	2.0
27	1.0	1.0	1.0	2.0	2.0
28	1.0	1.0	1.0	2.0	2.0
29	1.0	1.0	1.0	2.0	2.0
30	1.0	1.0	1.0	2.0	2.0
31	1.0	1.0	1.0	2.0	2.0
32	1.0	1.0	1.0	2.0	2.0
33	1.0	1.0	1.0	2.0	2.0
34	1.0	1.0	1.0	2.0	2.0
35	1.0	1.0	1.0	2.0	2.0
36	1.0	1.0	1.0	2.0	2.0
37	1.0	1.0	1.0	2.0	2.0
38	1.0	1.0	1.0	2.0	2.0
39	1.0	1.0	1.0	2.0	2.0
40	1.0	1.0	1.0	2.0	2.0
41	1.0	1.0	1.0	2.0	2.0
42	1.0	1.0	1.0	2.0	2.0
43	1.0	1.0	1.0	2.0	2.0
44	1.0	1.0	1.0	2.0	2.0
45	1.0	1.0	1.0	2.0	2.0
46	1.0	1.0	1.0	2.0	2.0
47	1.0	1.0	1.0	2.0	2.0
48	1.0	1.0	1.0	2.0	2.0
49	1.0	1.0	1.0	2.0	2.0
50	1.0	1.0	1.0	2.0	2.0
51	1.0	1.0	1.0	2.0	2.0
52	1.0	1.0	1.0	2.0	2.0
53	1.0	1.0	1.0	2.0	2.0
54	1.0	1.0	1.0	2.0	2.0
55	1.0	1.0	1.0	2.0	2.0
56	1.0	1.0	1.0	2.0	2.0
57	1.0	1.0	1.0	2.0	2.0
58	1.0	1.0	1.0	2.0	2.0
59	1.0	1.0	1.0	2.0	2.0
60	1.0	1.0	1.0	2.0	2.0
61	1.0	1.0	1.0	2.0	2.0
62	1.0	1.0	1.0	2.0	2.0
63	1.0	1.0	1.0	2.0	2.0
64	1.0	1.0	1.0	2.0	2.0
65	1.0	1.0	1.0	2.0	2.0
66	1.0	1.0	1.0	2.0	2.0
67	1.0	1.0	1.0	2.0	2.0
68	1.0	1.0	1.0	2.0	2.0
69	1.0	1.0	1.0	2.0	2.0
70	1.0	1.0	1.0	2.0	2.0
71	1.0	1.0	1.0	2.0	2.0
72	1.0	1.0	1.0	2.0	2.0
73	1.0	1.0	1.0	2.0	2.0
74	1.0	1.0	1.0	2.0	2.0
75	1.0	1.0	1.0	2.0	2.0
76	1.0	1.0	1.0	2.0	2.0
77	1.0	1.0	1.0	2.0	2.0
78	1.0	1.0	1.0	2.0	2.0
79	1.0	1.0	1.0	2.0	2.0
80	1.0	1.0	1.0	2.0	2.0
81	1.0	1.0	1.0	2.0	2.0
82	1.0	1.0	1.0	2.0	2.0
83	1.0	1.0	1.0	2.0	2.0
84	1.0	1.0	1.0	2.0	2.0
85	1.0	1.0	1.0	2.0	2.0
86	1.0	1.0	1.0	2.0	2.0
87	1.0	1.0	1.0	2.0	2.0
88	1.0	1.0	1.0	2.0	2.0
89	1.0	1.0	1.0	2.0	2.0
90	1.0	1.0	1.0	2.0	2.0
91	1.0	1.0	1.0	2.0	2.0
92	1.0	1.0	1.0	2.0	2.0
93	1.0	1.0	1.0	2.0	2.0
94	1.0	1.0	1.0	2.0	2.0
95	1.0	1.0	1.0	2.0	2.0
96	1.0	1.0	1.0	2.0	2.0
97	1.0	1.0	1.0	2.0	2.0
98	1.0	1.0	1.0	2.0	2.0
99	1.0	1.0	1.0	2.0	2.0
100	1.0	1.0	1.0	2.0	2.0

SEA INDUSTRIAL DEVELOPMENT CORPORATION

STATE OF TEXAS
 COUNTY OF HARRIS
 A DEVELOPMENT OF PLATS, ROADS AND PAVING
 BOUNDARY STONES AT BAYVIEW INDUSTRIAL PARK
 THE CITY OF HOUSTON, TEXAS

PREPARED BY: SEA INDUSTRIAL DEVELOPMENT CORPORATION 12000 WESTHOPE AVENUE, SUITE 100 HOUSTON, TEXAS 77040	TITLE: SUBDIVISION OF PLATS, ROADS AND PAVING BOUNDARY STONES AT BAYVIEW INDUSTRIAL PARK SHEET NO. 1 OF 1
DATE: 11/15/90	DRAWN BY: SEA
CHECKED BY: SEA	SCALE: AS SHOWN
APPROVED BY: SEA	PROJECT NO.: SEA-90-01

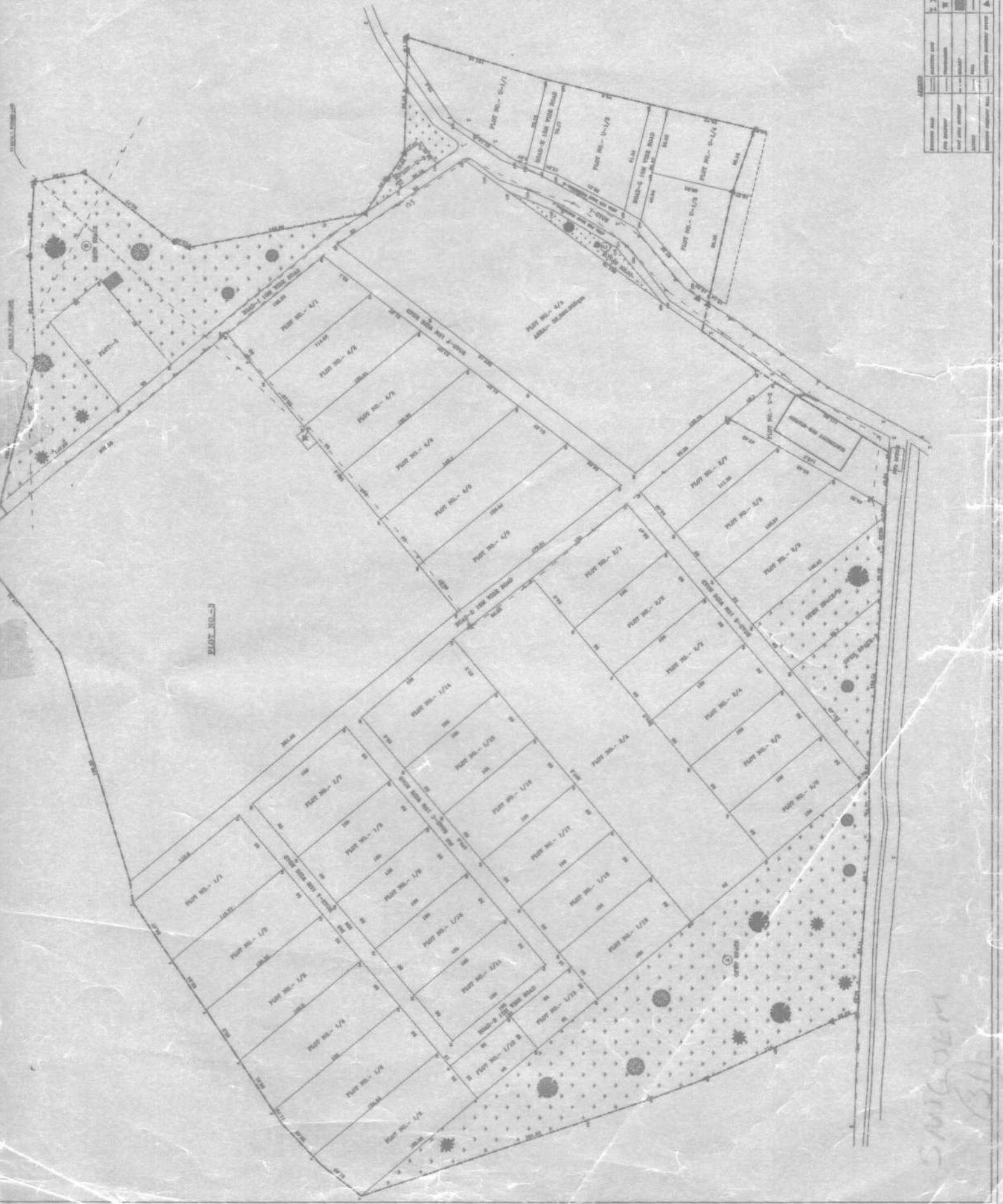

PREPARED BY: SEA INDUSTRIAL DEVELOPMENT CORPORATION 12000 WESTHOPE AVENUE, SUITE 100 HOUSTON, TEXAS 77040	TITLE: SUBDIVISION OF PLATS, ROADS AND PAVING BOUNDARY STONES AT BAYVIEW INDUSTRIAL PARK SHEET NO. 1 OF 1
DATE: 11/15/90	DRAWN BY: SEA
CHECKED BY: SEA	SCALE: AS SHOWN
APPROVED BY: SEA	PROJECT NO.: SEA-90-01

SMIGOLEM
 1311